

35 Watt, PS Series, Open Frame (Single Output)

ALL PSU LTD
Electronic Power Solutions

- Universal AC Input
- High Efficiency/Reliability
- 100% Full Load Burn In
- Short Circuit, Over Load, Over Voltage Protection
- Full Approvals: UL/TUV/CE
- 2 Year Warranty
- Compact size 4" x 2" Footprint
- Low 24 mm Profile
- High MTBF >588 khrs



Size 101.6 x 50.8 x 24 mm

Specification

Input Voltage.....	90~264 VAC, 47~440 Hz, (127~370 VDC)
Inrush current.....	Cold start, 23 A / 115 VAC, 45 A / 230 V
Output Voltage.....	See table below (plus +/-10% adjustment range)
Over Load Protection.....	105~150% output pulsing mode, (auto-recovery)
Over Voltage Protection.....	115~135% of output voltage
Setup, Rise, Hold up time.....	1200 ms, 30 ms, 10 ms/ 115 VAC 1200 ms, 30 ms, 50 ms / 230 VAC
Isolation Voltage.....	I/P-O/P: 3 kVAC, I/P-FG: 1.5 kVAC, O/P-FG: 0.5 kVAC
Operating Temperature.....	-20 to +50 °C for 100% load Derates to 50% load at +65 °C
Safety Standards.....	TUV EN60950-1, UL60950-1
EMC Standard.....	EN55022 (CISPR 22) class B, EN61000-3-2, 3 EN61000-4-2, 3, 4, 5, 6, 8, 11, ENV50204, EN55024 Light Industry level, criteria A
Connections.....	Plug in JST style 3.96 mm pitch

Optional metal safety covers are available if required.

Models and Ratings

Model	Output (VDC)	Max. Output Current	Ripple/Noise (p-p)	Efficiency
PS-35-3.3	3.3 V	6.0 A	80 mV	70%
PS-35-5	5.0 V	6.0 A	100 mV	78%
PS-35-7.5	7.5 V	4.7 A	100 mV	80%
PS-35-12	12.0 V	3.0 A	120 mV	81%
PS-35-13.5	13.5 V	2.6 A	120 mV	81%
PS-35-15	15.0 V	2.4 A	150 mV	81%
PS-35-24	24.0 V	1.5 A	200 mV	85%
PS-35-48	48.0 V	0.75 A	240 mV	84%

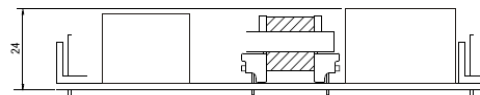
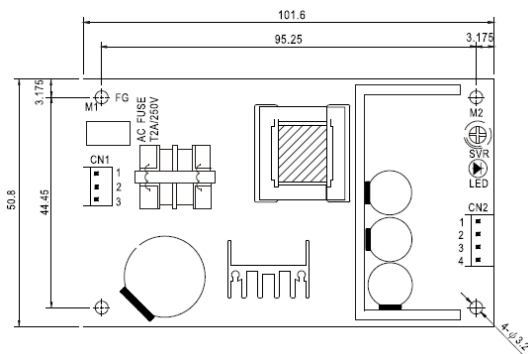

Specifications can change without notice, E&OE. ALL PSU Terms & Conditions apply.

**ALL PSU Ltd, Unit D6 Laser Quay, Culpeper Close, Medway City Estate,
Rochester, Kent, ME2 4HU, Tel: 01634 725527, Fax: 01634 739111,
Email: sales@allpsu.co.uk Web: www.allpsu.co.uk**