



50 Watt, A-50FAL Series, Enclosed Power Supply

- Universal AC Input
- High Efficiency up to 90%
- High Reliability, 3 year warranty
- Short Circuit, Over Load Protections
- CE & EN60950 Approved
- No Load Power Consumption <0.2W
- Stocked in the UK
- 1U Compatible Low profile 30mm Height



Specification

Input Voltage.....85-264 VAC, 47~63 Hz (120-370 VDC)
 Output Voltage.....See table below, plus Voltage adjustment range
 Over Load Protection.....110~150% of output
 Short Circuit Protection.....Hiccup mode, auto-recovery
 Set up, Rise, Hold Up Time.....typ. 1000 ms, 30 ms, 30 ms @ full load/230 VAC
 Isolation Voltage..... I/P-O/P: 3 kVAC, I/P-FG: 2kVAC, O/P-FG: 0.5kVAC
 Operating Temperature -30 to +70 °C, see derating curve
 Safety Standards.....EN60950-1, GB4943-2001, UL1012, CE
 EMC.....EN55022 CLASS B
 Mechanical Size & Weight.....99 x 82 x 30 mm, 0.23 Kg
 Connections Input & Output.....Screw terminals

Models and Ratings

Model	Output Voltage	Output Voltage Adj Range	Maximum Output Current	Efficiency
A-50FAL-5	5 Volts	4.5 to 5.5 Volts	10 Amps	83 %
A-50FAL-12	12 Volts	10.8 to 13.2 Volts	4.2 Amps	85 %
A-50FAL-24	24 Volts	21.6 to 26.4 Volts	2.2 Amps	88 %
A-50FAL-36	36 Volts	32.4 to 39.6 Volts	1.45 Amps	89 %
A-50FAL-48	48 Volts	43.2 to 52.8 Volts	1.1 Amps	90 %

Please see next page for mechanical drawings, connections and derating.

50 Watt, A-50FAL Series, Enclosed Power Supply



electronicpowersolutions

Mechanical Drawings and Connection Details

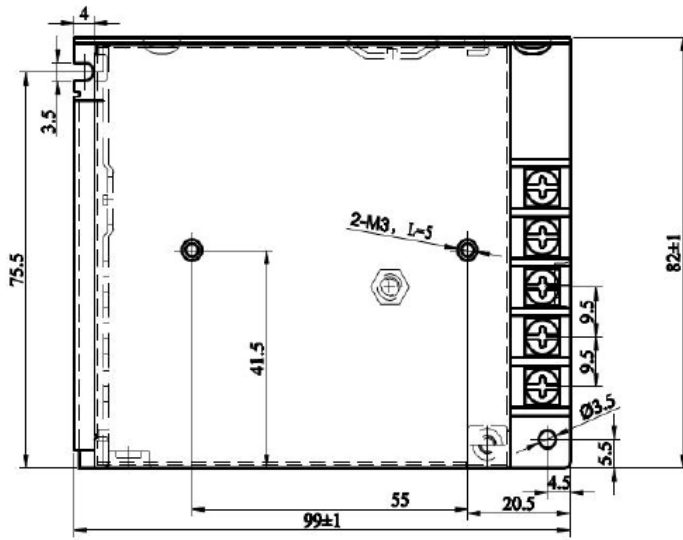

Pin No.	Assignment	Pin No.	Assignment
1	AC/L	4	DC output (V-)
2	AC/N	5	DC output (V+)
3	FG		

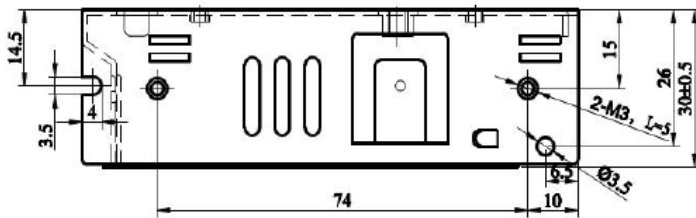

Temperature and AC Input Derating Curves :

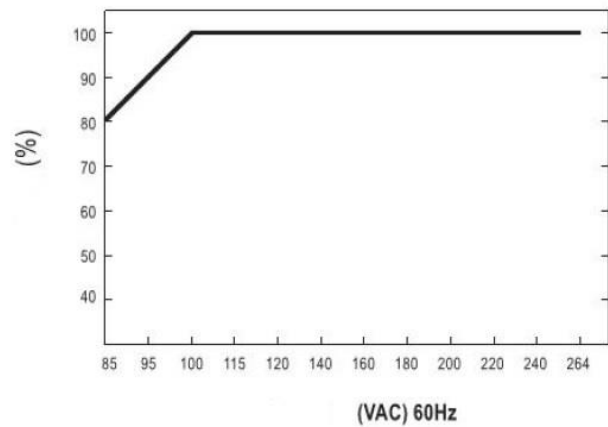
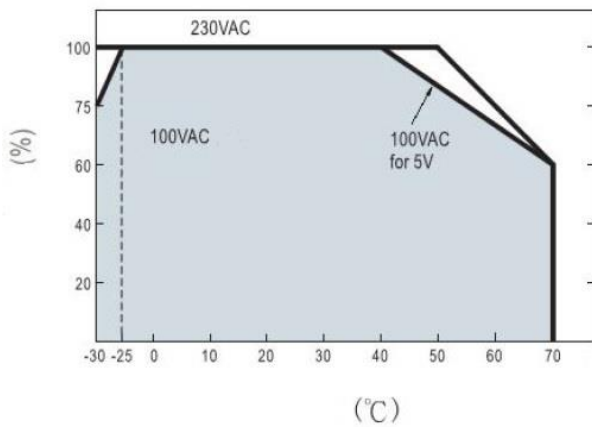

Specifications may change without notice. E&OE. ALL PSU Terms & Conditions apply.

**ALL PSU Ltd, Unit D6 Laser Quay, Culpeper Close, Medway City Estate,
Rochester, Kent, ME2 4HU, Tel : 01634 725527, Fax : 01634 739111,
Email : sales@allpsu.co.uk Web : www.allpsu.co.uk**