



FEATURES	SAFETY APPROVALS	PRODUCTS PICTURE
<ul style="list-style-type: none"> ❖ EFFICIENCY VI ❖ 12-30 WATT OUTPUT POWER ❖ OVERCURRENT PROTECTION ❖ SHORT CIRCUIT PROTECTION ❖ INPUT PROTECTION ❖ ROHS COMPLIANT 	<ul style="list-style-type: none"> ❖ CE ❖ GS ❖ ROHS ❖ REACH 	

TYPICAL MODEL LIST

I/P Voltage	Typical model	Output Voltage	Output Current	Ripple & noise	Efficiency
90 - 264V 47 - 63HZ	SAW30-090-2000	9V	2000mA	90mV	VI
	SAW30-090-3000	9V	3000mA	90mV	VI
	SAW30-120-2000	12V	2000mA	120mV	VI
	SAW30-120-2500	12V	2500mA	120mV	VI
	SAW30-180-1000	18V	1000mA	150mV	VI
	SAW30-240-1000	24V	1000mA	150mV	VI

INPUT SPECIFICATIONS	GENERAL SPECIFICATIONS
----------------------	------------------------

Input Voltage	90~264VAC	Primary to Secondary	50MΩ MIN
Input Frequency	47~63Hz	Efficiency	VI
Input Current	1.2A Max	Standby Power	0.1W MAX
Inrush Current	40A Max	Leakage Current	0.25mA MAX

OUTPUT SPECIFICATIONS	ENVIRONMENTAL SPECIFICATIONS
-----------------------	------------------------------

Output Voltage Range	5V-36V	Operating Temperature	10°C~40°C
Output Current Range	100mA-5000mA	Cooling	Convection
Output Power Range	30W Max	Temperature Coefficient	0.05%/°C
Short Circuit Protection	Automatic Recovery	Humidity	5~95%RH(non-condensing)
Over-Current Protection	Automatic Recovery	Storage Temperature	-20°C~+80°C

RIPPLE AND NOISE	PHYSICAL SPECIFICATIONS
------------------	-------------------------

Ripple and Noise	100mVp-p max	Physical Specifications	71.2mm*43.2mm*29mm
Turn On Time	20-30mS normal	SAFETY STANDARD	
Line Regulation	1% max		

Output Regulation	±5%	Safety Standard	62368/ 60335/ 61558/ 60065
--------------------------	-----	------------------------	----------------------------

MECHANICAL SPECIFICATION	PACKING DETAILS
--------------------------	-----------------

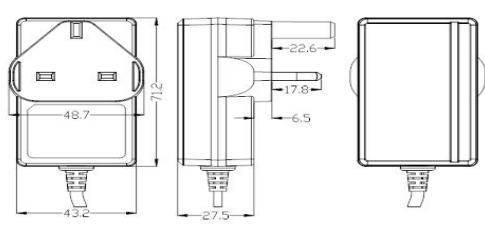

100pcs/carton, 15kg/carton
Carton size: 47*36.5*19cm